

PIN-FLAT 6-LOBE MACHINE SCREW

Please order this product by part number.

	M3	M4	M5	M6
dk	6	8	10	12
k	1.75	2.3	2.8	3.4
drive #	T10	T20	T25	T30

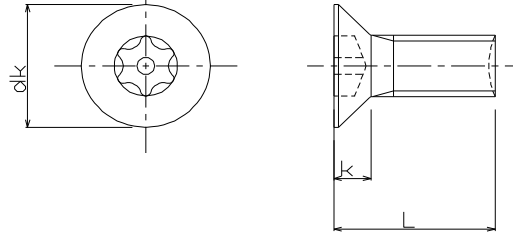

steel zinc plated

USD/100pcs

SIZE	PART #	box qty	1-9 boxes	10 & above boxes
M3x5	R830-TX120305ZP	3,000	\$1.80	call us
6	R830-TX120306ZP	3,000	\$1.50	call us
8	R830-TX120308ZP	3,000	\$1.50	call us
10	R830-TX120310ZP	2,000	\$1.70	call us
M4x8	R830-TX120408ZP	2,000	\$2.80	call us
10	R830-TX120410ZP	1,500	\$2.60	call us
12	R830-TX120412ZP	1,500	\$2.80	call us
M5x10	R830-TX120510ZP	1,000	\$4.80	call us
12	R830-TX120512ZP	1,000	\$4.80	call us
15	R830-TX120515ZP	700	\$4.80	call us
16	R830-TX120516ZP	700	\$5.00	call us
M6x12	R830-TX120612ZP	500	\$6.90	call us
15	R830-TX120615ZP	500	\$7.10	call us
20	R830-TX120620ZP	400	\$7.90	call us

steel zinc yellow plated

USD/100pcs

SIZE	PART #	box qty	1-9 boxes	10 & above boxes
M3x5	R830-TX120305ZY	3,000	\$1.80	call us
6	R830-TX120306ZY	3,000	\$1.50	call us
8	R830-TX120308ZY	3,000	\$1.50	call us
10	R830-TX120310ZY	2,000	\$1.70	call us
M4x8	R830-TX120408ZY	2,000	\$2.80	call us
10	R830-TX120410ZY	1,500	\$2.60	call us
12	R830-TX120412ZY	1,500	\$2.80	call us
M5x10	R830-TX120510ZY	1,000	\$4.80	call us
12	R830-TX120512ZY	1,000	\$4.80	call us
15	R830-TX120515ZY	700	\$4.80	call us
16	R830-TX120516ZY	700	\$5.00	call us
M6x12	R830-TX120612ZY	500	\$6.90	call us
15	R830-TX120615ZY	500	\$7.10	call us
20	R830-TX120620ZY	400	\$7.90	call us

steel Ni plated

USD/100pcs

SIZE	PART #	box qty	1-9 boxes	10 & above boxes
M3x5	R830-TX120305Ni	3,000	\$2.20	call us
6	R830-TX120306Ni	3,000	\$2.10	call us
8	R830-TX120308Ni	3,000	\$1.90	call us
10	R830-TX120310Ni	2,000	\$2.10	call us
M4x8	R830-TX120408Ni	2,000	\$3.50	call us
10	R830-TX120410Ni	1,500	\$3.50	call us
12	R830-TX120412Ni	1,500	\$3.70	call us
M5x10	R830-TX120510Ni	1,000	\$6.60	call us
12	R830-TX120512Ni	1,000	\$6.60	call us
15	R830-TX120515Ni	700	\$7.00	call us
16	R830-TX120516Ni	700	\$7.20	call us
M6x12	R830-TX120612Ni	500	\$10.00	call us
15	R830-TX120615Ni	500	\$10.30	call us
20	R830-TX120620Ni	400	\$11.80	call us

steel zinc black

USD/100pcs

SIZE	PART #	box qty	1-9 boxes	10 & above boxes
M3x5	R830-TX120305ZB	3,000	\$2.20	call us
6	R830-TX120306ZB	3,000	\$2.10	call us
8	R830-TX120308ZB	3,000	\$1.90	call us
10	R830-TX120310ZB	2,000	\$2.10	call us
M4x8	R830-TX120408ZB	2,000	\$3.50	call us
10	R830-TX120410ZB	1,500	\$3.50	call us
12	R830-TX120412ZB	1,500	\$3.70	call us
M5x10	R830-TX120510ZB	1,000	\$6.60	call us
12	R830-TX120512ZB	1,000	\$6.60	call us
15	R830-TX120515ZB	700	\$7.00	call us
16	R830-TX120516ZB	700	\$7.20	call us
M6x12	R830-TX120612ZB	500	\$10.00	call us
15	R830-TX120615ZB	500	\$10.30	call us
20	R830-TX120620ZB	400	\$11.80	call us

MARYLAND METRICS

phones: (410)358-3130 (800)638-1830 faxes: (410)358-3142 (800)872-9329

URL: <http://mdmetric.com> E-mail: techinfo@mdmetric.com

P.O.Box 261 Owings Mills, MD 21117 USA

FASTENER CATALOG - CHAPTER S

Many items in chapter S are not stocked in the US. Please allow adequate lead time for delivery and factory minimum order requirements.

PIN-FLAT 6-LOBE MACHINE SCREW

Please order this product by part number.

steel Chrome plated

USD/100pcs

SIZE	PART #	box q'ty	1-9 boxes	10 & above boxes
M3x5	R830-TX120305Cr	3,000	\$4.10	call us
6	R830-TX120306Cr	3,000	\$3.90	call us
8	R830-TX120308Cr	3,000	\$3.80	call us
10	R830-TX120310Cr	2,000	\$3.90	call us
M4x8	R830-TX120408Cr	2,000	\$5.70	call us
10	R830-TX120410Cr	1,500	\$5.40	call us
12	R830-TX120412Cr	1,500	\$5.90	call us
M5x10	R830-TX120510Cr	1,000	\$9.90	call us
12	R830-TX120512Cr	1,000	\$9.90	call us
15	R830-TX120515Cr	700	\$10.20	call us
16	R830-TX120516Cr	700	\$10.70	call us
M6x12	R830-TX120612Cr	500	\$12.50	call us
15	R830-TX120615Cr	500	\$12.70	call us
20	R830-TX120620Cr	400	\$13.80	call us

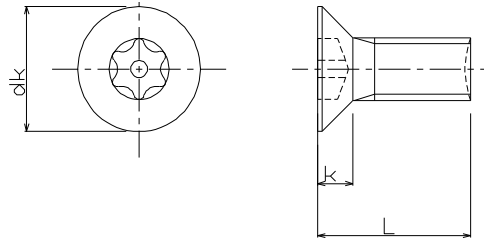

A tamper proof style screw that requires a 6-lobe hex key with hole for installation or removal

MARYLAND METRICS
 phones: (410)358-3130 (800)638-1830 faxes: (410)358-3142 (800)872-9329
 URL: <http://mdmetric.com> E-mail: techinfo@mdmetric.com
 P.O.Box 261 Owings Mills, MD 21117 USA
FASTENER CATALOG - CHAPTER S

Many items in chapter S are not stocked in the US . Please allow adequate lead time for delivery and factory minimum order requirements.