

PIN-PAN 6-LOBE TAPPING SCREW
type A, stainless A2

	4
dk	7
k	2.6
drive #	T20

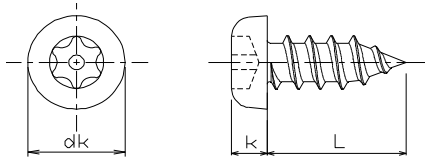

Please order this product by part number. USD/100pcs

SIZE	PART #	box q'ty	1-9 boxes	10 & above boxes
4x8	R830-TX310408	1,000	\$8.80	call us
10	R830-TX310410	1,000	\$9.10	call us
12	R830-TX310412	1,000	\$9.70	call us
16	R830-TX310416	1,000	\$10.60	call us
20	R830-TX310420	500	\$11.30	call us
25	R830-TX310425	500	\$14.20	call us
30	R830-TX310430	500	\$15.30	call us

PIN-FLAT 6-LOBE TAPPING SCREW
type A, stainless A2

	4
dk	8
k	2.3
drive #	T20

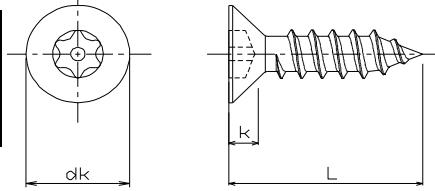

Please order this product by part number. USD/100pcs

SIZE	PART #	box q'ty	1-9 boxes	10 & above boxes
4x8	R830-TX320408	2,000	\$11.50	call us
10	R830-TX320410	1,000	\$9.10	call us
12	R830-TX320412	1,000	\$9.70	call us
16	R830-TX320416	1,000	\$10.60	call us
20	R830-TX320420	500	\$11.30	call us
25	R830-TX320425	500	\$14.20	call us
30	R830-TX320430	500	\$15.30	call us

PIN-TRUSS 6-LOBE TAPPING SCREW
type A, stainless A2

	4
dk	9.4
k	2.5
drive #	T20

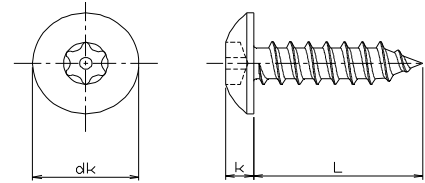

Please order this product by part number. USD/100pcs

SIZE	PART #	box q'ty	1-9 boxes	10 & above boxes
4x8	R830-TX330408	1,000	\$12.00	call us
10	R830-TX330410	1,000	\$12.30	call us
12	R830-TX330412	1,000	\$12.70	call us
16	R830-TX330416	500	\$13.50	call us
20	R830-TX330420	500	\$14.10	call us
25	R830-TX330425	500	\$17.10	call us
30	R830-TX330430	500	\$18.10	call us

PIN-PAN HEAD 6-LOBE SELF DRILL SCREW
410 stainless

Please order this product by part number.

	4.2
dk	8.17
k	2.92
drive #	T20

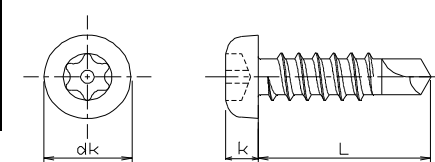

USD/100pcs

SIZE	PART #	box q'ty	1,000 pcs and above
4.2X13	R830-TX050413	1,000	\$9.80
16	R830-TX050416	1,000	\$11.20
16	R830-TX050419	1,000	\$11.20

* 1,000PCS PACKAGE ONLY

Call us for price 10,000pcs and above.

A tamper proof style screw that requires a 6-lobe hex key with hole for installation or removal

MARYLAND METRICS
phones: (410)358-3130 (800)638-1830 faxes: (410)358-3142 (800)872-9329
URL: <http://mdmetric.com> E-mail: techinfo@mdmetric.com
P.O.Box 261 Owings Mills, MD 21117 USA
FASTENER CATALOG - CHAPTER S

Many items in chapter S are not stocked in the US. Please allow adequate lead time for delivery and factory minimum order requirements.

PIN BUTTON 6-LOBE TAPPING SCREW
stainless A2

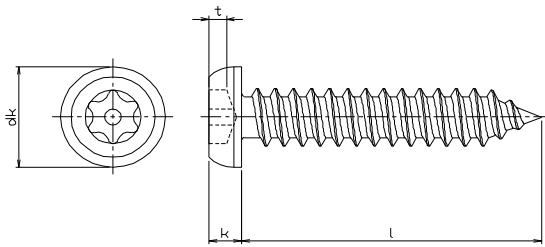

	3.5	4.2	4.8
dk	6.66	7.93	9.17
k	1.86	2.21	2.57
drive #	T10	T15	T20

Please order this product by part number.

USD/100pcs

SIZE	PART #	box q'ty	100 pcs	1,000 pcs & above
ST3.5x13	R830-TX033513	100	\$64.00	\$54.30
20	R830-TX033520	100	\$72.20	\$61.50
25	R830-TX033525	100	\$80.50	\$68.50
38	R830-TX033538	100	\$82.20	\$69.90
ST4.2x13	R830-TX034213	100	\$65.20	\$55.40
20	R830-TX034220	100	\$67.50	\$57.40
25	R830-TX034225	100	\$71.40	\$60.80
32	R830-TX034232	100	\$83.20	\$70.70
38	R830-TX034238	100	\$88.20	\$75.00
ST4.8x13	R830-TX034813	100	\$69.20	\$58.80
20	R830-TX034820	100	\$71.40	\$60.80
25	R830-TX034825	100	\$77.80	\$66.20
32	R830-TX034832	100	\$98.00	\$82.90
38	R830-TX034838	100	\$109.20	\$93.20

PIN-FLAT 6-LOBE TAPPING SCREW
stainless A2

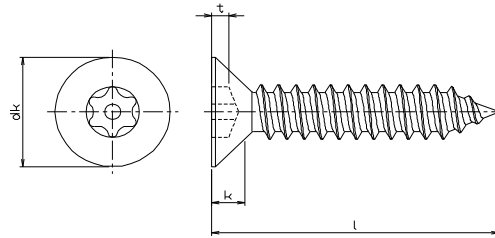

	3.5	4.2	4.8
dk	7.8	9.12	10.44
k	2.47	2.85	3.23
drive #	T15	T20	T25

Please order this product by part number.

USD/100pcs

SIZE	PART #	box q'ty	100 pcs	1,000 pcs & above
ST3.5x13	R830-TX043513	100	\$64.40	\$54.30
20	R830-TX043520	100	\$72.80	\$61.50
25	R830-TX043525	100	\$81.20	\$68.50
38	R830-TX043538	100	\$82.60	\$69.90
ST4.2x13	R830-TX044213	100	\$65.80	\$55.40
20	R830-TX044220	100	\$67.20	\$57.40
25	R830-TX044225	100	\$71.40	\$60.80
32	R830-TX044232	100	\$82.60	\$70.70
38	R830-TX044238	100	\$88.20	\$75.00
ST4.8x13	R830-TX044813	100	\$68.60	\$58.80
20	R830-TX044820	100	\$71.40	\$60.80
25	R830-TX044825	100	\$78.40	\$66.20
32	R830-TX044832	100	\$98.00	\$82.90
38	R830-TX044838	100	\$109.20	\$93.20

6-LOBE POWER BIT for TRF

SIZE	PART #	box q'ty	USD/100		
			1-44	50pcs	100 pcs
T20	R830-TX20B65	1	\$1,260.00	call us	call us

hex shank: 6.35mm (1/4')

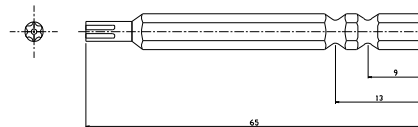

A tamper proof style screw that requires a 6-lobe hex key with hole for installation or removal

MARYLAND METRICS
 phones: (410)358-3130 (800)638-1830 faxes: (410)358-3142 (800)872-9329
 URL: <http://mdmetric.com> E-mail: techinfo@mdmetric.com
 P.O.Box 261 Owings Mills, MD 21117 USA
FASTENER CATALOG - CHAPTER S

Many items in chapter S are not stocked in the US. Please allow adequate lead time for delivery and factory minimum order requirements.