

# 10.9

Socket button head screws, steel

ISO 7380

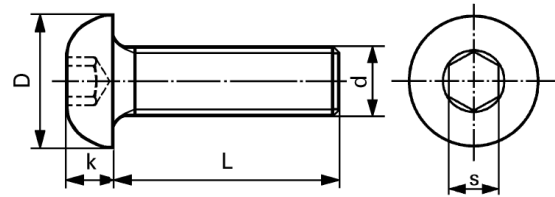

d	M3		M4		M5		M6	
D	5,7		7,6		9,5		10,5	
s	2		2,5		3		4	
k	1,65		2,2		2,75		3,3	
L quantity	100	1000+	100	1000+	100	1000+	100	1000+
6	17.40	11.90	17.80	12.50	22.-	15.90	27.-	19.50
8	17.40	11.90	17.60	12.40	21.25	15.30	24.-	17.40
10	17.40	11.90	18.80	13.20	19.70	14.30	21.50	15.40
12	17.90	12.40	19.-	13.50	19.70	14.30	20.25	14.70
(14)	21.50	15.30	24.-	17.40	24.75	17.90	28.25	20.50
16	20.25	14.70	21.50	15.70	22.-	15.90	22.25	16.-
(18)			24.25	17.70	25.25	18.40	24.50	17.80
20	24.25	17.40	22.-	15.90	23.50	17.20	22.25	16.-
(22)			26.-	20.50	26.-	19.70		
25	26.-	19.80	27.75	22.-	27.75	20.25	25.-	18.-
30					31.75	23.75	27.-	19.50
35			38.-	31.50	35.75	27.-	30.25	22.25
40			45.-	38.90	39.50	29.75	31.25	23.50
50					63.50	47.50	56.-	42.-
55							91.-	69.-
Reduced tightening and loads: refer to page T 25								

+ 10% discount for 10 000 pieces per item

# 10.9

Socket button head screws, steel

ISO 7380

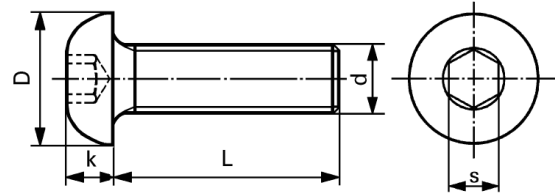

d	M8		M10		M12
D	14		17,5		21
s	5		6		8
k	4,4		5,5		6,6
L quantity	100	1000+	100	1000+	100
10	31.75	23.75			
12	29.-	21.25			
(14)	34.50	25.75			
16	29.75	22.50	52.50	39.50	108.-
(18)	38.25	29.-			
20	29.-	22.-	50.-	38.-	78.-
25	30.50	23.-	52.50	39.50	73.50
30	32.25	24.25	54.50	41.50	78.-
35	35.75	27.-	59.-	44.50	86.50
40	39.75	30.-	65.50	49.50	88.50
45	43.-	31.-	90.-	76.50	95.50
50	46.50	34.50			105.-
60	66.-	53.-	115.-	91.-	
70	70.-	56.-			
80	157.-	124.-			

Reduced tightening and loads:  
refer to page T 25

+ 10% discount for 10 000 pieces per item

# 10.9

Socket button head screws, steel

ISO 7380

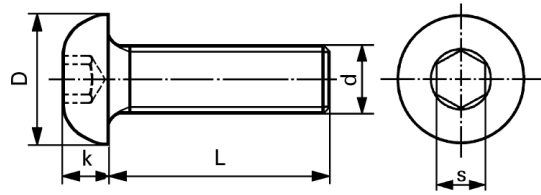

Zinc plated, baked (hydrogen embrittlement relieved)

d	M3		M4		M5		M6	
D	5,7		7,6		9,5		10,5	
s	2		2,5		3		4	
k	1,65		2,2		2,75		3,3	
L quantity	100	1000+	100	1000+	100	1000+	100	1000+
6	23.-	13.70	25.-	16.30	27.25	18.60		
8	23.-	13.70	23.75	14.70	26.75	18.40	29.75	21.-
10	23.25	13.80	25.-	16.30	25.75	17.50	27.75	19.40
12	23.75	14.50	25.50	16.80	25.90	17.70	27.-	18.80
(14)			29.-	20.-	30.25	21.50	34.50	24.50
16	26.-	17.-	27.75	18.40	27.50	19.50	29.-	20.50
(18)			30.25	20.50	31.25	22.-	31.75	22.50
20			28.50	18.90	29.50	21.-	29.50	21.-
(22)					34.50	24.50		
25			33.50	23.25	34.50	24.50	33.-	23.75
30			55.-	45.50	39.50	28.50	35.75	25.75
35					55.-	44.50	42.-	29.25
40					69.50	58.10	52.-	34.75
45							65.-	51.-
50					86.50	71.20	71.-	57.-
65							95.-	81.-
Reduced tightening and loads: refer to page T 25								
Zinc plated high-strength steel: refer to page T 79								

+ 10% discount for 10 000 pieces per item

# 10.9

Socket button head screws, steel

## ISO 7380

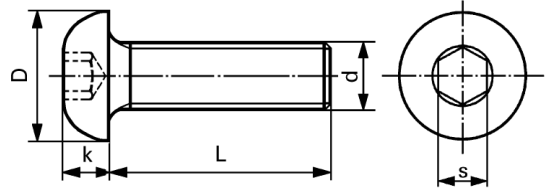

Zinc plated, baked (hydrogen embrittlement relieved)

d	M 8		M 10		M 12
D	14		17,5		21
s	5		6		8
k	4,4		5,5		6,6
L quantity	100	1000+	100	1000+	100
10	46.-	34.-			
12	44.50	33.-			
(14)	54.50	40.50			
16	40.-	29.50	68.-	50.-	129.-
(18)	50.-	37.-			
20	40.50	30.-	67.-	49.50	100.-
25	43.-	32.-	71.50	53.-	98.50
30	46.50	34.50	73.-	56.-	105.-
35	52.50	38.75	80.-	61.50	116.-
40	58.-	43.-	88.-	68.-	122.-
45	76.50	63.50	105.-	85.-	132.-
50	82.-	69.20			
55	108.-	88.-			
<div style="border: 1px solid black; padding: 5px; margin: 5px 0;">                     Reduced tightening and loads: refer to page T 25                 </div> <div style="border: 1px solid black; padding: 5px; margin: 5px 0;">                     Zinc plated high-strength steel: refer to page T 79                 </div>					

+ 10% discount for 10 000 pieces per item