

Square nuts, steel

DIN 557

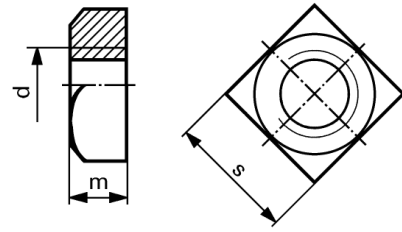

d	s	m	zinc plated		
			max.		
quantity			100	1000	10 000
M					
5	8	4	6.50	4.-	2.90
6	10	5	6.70	4.30	3.30
8	13	6,5	12.50	8.80	8.10
10	17	8	20.50	15.60	14.70
12	19	10	38.75	24.75	22.50
16	24	13	82.-	56.-	51.50
20	30	16	189.-	132.-	105.-

Square nuts, steel

DIN 562

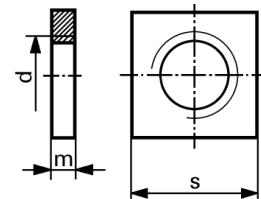

d	s	m	zinc plated		
			max.		
quantity			100	1000	10 000
M					
2	4	1,2	5.20	2.65	2.-
2,5	5	1,6	5.20	2.65	2.-
3	5,5	1,8	5.20	2.15	1.60
3,5	6	2	5.20	2.65	2.-
4	7	2,2	5.20	2.30	1.70
5	8	2,7	5.90	3.70	2.20
6	10	3,2	6.30	4.-	3.-
8	13	4	12.90	8.30	6.60
10	17	5	18.60	13.50	12.80

Square nuts, steel

K 460

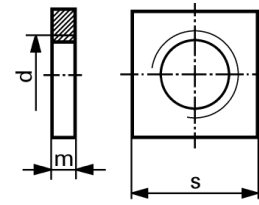

d	s	m	zinc plated		
	h14	h14			
quantity			100	1000	10 000
M					
4	18	4	20.75	18.20	16.90
4	*20	4	27.25	23.25	20.92
5	18	4	19.80	17.40	16.20
5	*14	4	42.–	32.60	30.50
5	*20	4	27.25	23.25	20.92
5+6	18	4	50.60	39.20	36.80
6	18	4	18.50	15.50	14.40
6	*20	4	21.30	18.50	16.65
8	18	4	22.50	19.40	18.80
8	*20	4	26.40	22.50	20.30
8	18	**5	21.30	18.50	16.65

Rectangular nuts, steel

K 462

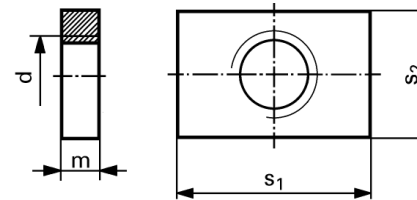

d	s1	s2	m	zinc plated		
	h14	h13	h14			
quantity				100	1000	10 000
M						
3	18,5	10	3	19.20	13.20	11.30
4	18,5	10	4	15.20	10.70	10.–
5	18,5	10	4	15.50	11.–	11.30
6	18,5	10	4	15.50	11.–	11.30

* for that size note width across flats «s» (L0020)

** for that size note height «m» (L0500)

Rhomboid nuts, steel

K 464

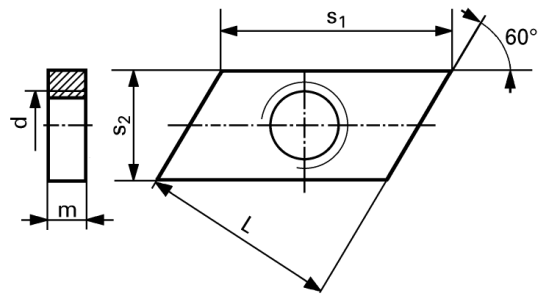

d	L	s1	s2	m	zinc plated		
					100	1000	10 000
	h15	h15	h13	h14			
quantity					100	1000	10 000
M							
4	19	21,3	10	4	18.-	13.50	12.80
5	19	21,3	10	4	18.20	13.80	13.-
6	19	21,3	10	4	18.20	13.80	13.-

Hex weld nuts, steel

DIN 929

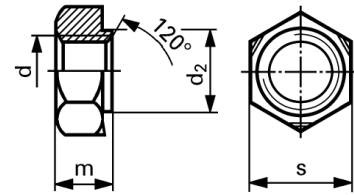

d	s	m	d2	plain		
quantity			d11	100	1000	10 000
M						
3	7,5	3	4,5	6.50	3.65	3.50
4	9	3,5	6	6.-	3.55	3.-
5	10	4	7	6.70	3.85	3.60
6	11	5	8	8.10	4.30	3.95
8	14	6,5	10,5	9.50	6.50	5.90
10	17 ISO 16	8	12,5	15.20	10.30	9.40
12	19 ISO 18	10	14,8	23.75	15.80	13.70
(14)	22 ISO 21	11	16,8	57.50	41.50	35.25
16	24	13	18,8	61.-	43.-	37.50

Spot weld nuts, steel

K 412

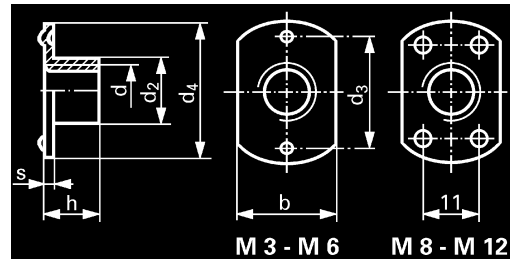

d	b	d4	h	s	d3	d2	plain	
quantity							100	1000
M								
3	9	17	5	0,9	12	4,2	26.75	19.50
4	9	17	6	0,9	12	5	25.-	18.20
5	11	19	7,5	1,2	14	6,5	25.75	18.30
6	14	22	8,5	1,5	16	7,7	27.60	21.05
8	18	26	10	1,8	16	10,1	35.-	26.10
10	18	26	10,5	1,9	16	11,9	47.-	36.50
12	20,5	29	12,5	2,2	17	14,3	78.-	53.50