

Rivet nuts, steel

K 420

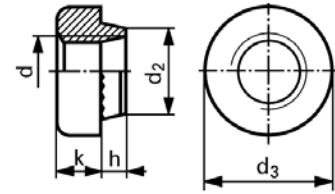

d	d3	k	h	d2	sheet	hole size	zinc plated	
					é			
quantity	h14				max.	+ 0,15	100	1000
M								
4	9,5	3,18	2	6,4	1,62	6,5	36.75	27.75
5	11,1	3,81	2,3	7,9	1,62	8	37.50	28.60
6	12,7	5,08	2,8	9,2	1,62	9,3	46.-	35.-
8	15,9	6,35	3,2	12,6	2,03	12,7	57.50	46.-
10	19	7,62	4	15	3,25	15,1	82.-	68.-

T-nuts with pronges, steel

K 410

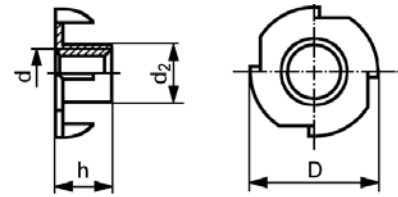

d	D	d2	h	plain			zinc plated		
				100	1000	10 000	100	1000	10 000
quantity									
M									
3	13	4,3	5,0	23.-	18.30	15.40	23.50	19.10	16.40
4	15	5,0	6,0	16.30	12.90	10.70	17.30	13.90	11.80
5	17	6,3	8,0	19.90	15.90	12.70	20.50	16.80	13.70
6	19	7,3	9,0	23.-	18.30	15.40	24.60	19.85	15.70
8	22	9,7	11,0	32.50	23.25	20.75	34.10	25.20	22.40
10	25	11,9	12,0	42.50	36.25	31.-	46.50	38.50	33.50
12	27	13,7	14,0	55.-	49.80	45.60			

Countersunk, slotted nuts, steel

K 419

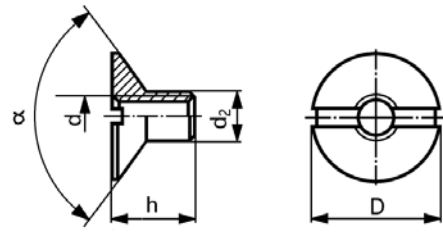

d	D	h	a	d2	zinc plated	
					100	1000
	h14	js17		h14		
quantity					100	1000
M						
3	10	5,5	90°	4	48.-	42.-
4	12	6	90°	5	58.50	52.50
5	14	7	90°	6	51.-	45.50
6	16	8	90°	7	56.-	48.-
6	* 18	9	110°	7	24.75	20.75
8	20	10	90°	9	60.-	53.-
10	24	12	90°	12	145.-	107.-

* for paletts, note diameter «D»

Slotted round nuts, steel

DIN 546

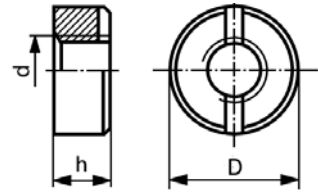

d	D	h	plain		zinc plated	
			100	1000	100	1000
	h14	h14				
quantity			100	1000	100	1000
M						
2	4,5	2			21.25	14.10
3	6	2,5	14.30	10.70	14.40	10.80
4	8	3,5	15.20	11.50	15.60	11.70
5	9	4,2	19.60	14.70	20.–	15.20
6	11	5	27.–	20.25	27.75	21.–
8	14	6,5	52.–	41.–	53.50	42.–
10	18	8	104.–	85.–	107.–	87.50

Knurled nuts, steel
high type

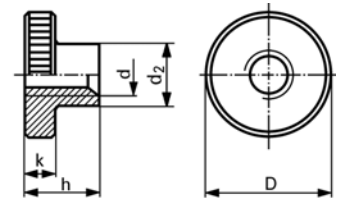

DIN 466

d	d2	D	h	k	zinc plated	
	h14	js15	h14	h14		
quantity					100	1000
M						
2.5	5	11	5,5	2,5	177.-	146.-
3	6	12	7,5	2,5	31.-	24.25
4	8	16	9,5	3,5	43.50	35.25
5	10	20	11,5	4	66.-	53.50
6	12	24	15	5	95.-	85.50
8	16	30	18	6	141.-	118.-
10	20	36	23	8	280.-	229.-

Knurled nuts, low type

DIN 467

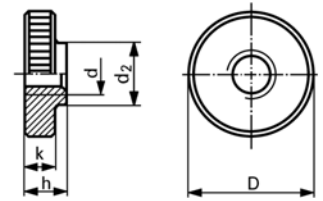

d	d2	D	h	k	zinc plated	
	h14	js14	h14	h14		
quantity					100	1000
M						
3	6	12	3	2,5	31.-	23.-
4	8	16	4	3,5	43.-	31.75
5	10	20	5	4	47.50	37.50
6	12	24	6	5	73.-	56.50
8	16	30	8	6	119.-	102.-
10	20	36	10	8	198.-	159.-

TG

Wing nuts, malleable casting

DIN 315

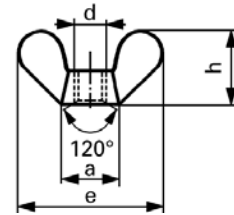

d	a max.	e max.	h max.	plain		zinc plated	
				100	1000	100	1000
quantity				100	1000	100	1000
M							
4	8	20	10,5	21.10	16.50	23.25	17.10
5	11	26	13	22.25	17.70	25.25	18.-
6	13	33	17	31.30	23.50	33.50	24.25
8	16	39	20	43.-	33.-	48.-	39.25
10	20	51	25	71.90	55.-	75.-	58.50
12	23	65	33,5	123.-	99.10	133.-	105.-
(14)	29	73	37,5	162.-	134.-	177.-	146.-
16	29	73	37,5	210.-	181.-	249.-	205.-
20	35	90	46,5	505.-	435.-	590.-	500.-

TG

Wing nuts, american type, steel

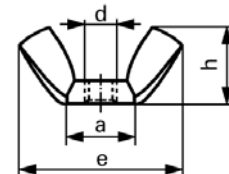

d	a max.	e max.	h max.	plain		zinc plated	
				100	1000	100	1000
quantity				100	1000	100	1000
M							
3	8	17,6	8,6	13.80	9.50	15.60	10.80
4	8	17,6	8,6	12.20	9.10	12.70	9.50
5	10,3	22,5	11	12.90	9.40	13.30	10.30
6	12,7	27,8	13,6	14.70	11.80	15.05	12.10
8	13,8	30,3	14,8	18.55	14.60	19.90	15.95
10	16,5	36,2	17,7	24.50	19.30	26.-	20.20
12	22,5	49,4	24,1	49.30	38.70	51.-	40.60