

CU

Sealing rings, copper

DIN 7603 A

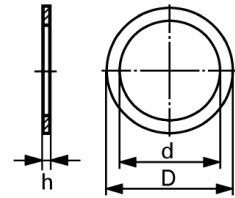

d	D x h	plain			d	D x h	plain		
		100	1000	10 000			100	1000	10 000
H13	h14 ±0,1				H13	h14 ±0,1			
4	8,0 x 1,0	11.40	7.30	5.30	17	23 x 1,5	36.75	27.75	25.-
5	7,5 x 1,0	16.80	11.40	8.80	17	24 x 5,0	128.-	105.-	94.50
5	9,0 x 1,0	11.40	7.30	4.90	17	26 x 2,0	77.-	60.-	54.-
5,5	8,0 x 1,0	18.70	12.40	10.10	18	22 x 1,5	30.75	22.25	20.-
6	10,0 x 1,0	9.60	5.80	4.80	18	24 x 1,5	36.50	27.75	25.-
6	10,0 x 1,5	14.50	9.60	7.80	20	24 x 1,5	35.25	26.50	
6	12,0 x 1,0	13.20	8.60	6.90	20	26 x 1,5	42.-	32.-	
6,5	9,5 x 1,0	9.10	6.10	4.95	21	26 x 1,5	40.-	30.50	
6,5	11,0 x 1,0	18.40	12.20	9.80	21	28 x 1,5	55.50	43.-	
8	11,5 x 1,0	10.40	6.50	5.35	22	27 x 1,5	40.-	30.50	
8	12,0 x 1,0	10.70	6.70	5.40	22	29 x 1,5	56.50	43.50	
8	12,0 x 1,5	16.70	11.30	9.10	23	28 x 2,0	54.-	41.50	
8	13,0 x 1,0	14.50	9.60	7.80	24	29 x 1,5	60.-	46.50	
8	14,0 x 1,0	12.80	8.30	6.50	24	29 x 2,0	55.50	42.50	
10	13,5 x 1,0	11.70	7.40	5.90	24	32 x 2,0	66.50	51.50	
10	14,0 x 1,0	12.30	7.90	6.40	25	30 x 2,0	57.50	44.50	
10	14,0 x 1,5	18.-	12.30	10.-	26	31 x 2,0	53.50	41.-	
10	15,0 x 1,0	14.90	9.90	8.10	26	32 x 2,0	57.50	44.50	
10	16,0 x 1,0	14.80	9.80	8.-	27	32 x 1,5	52.-	40.-	
12	15,5 x 1,0	16.80	11.40	9.20	27	32 x 2,0	57.50	44.50	
12	15,5 x 1,5	15.10	10.10	8.10	27	35 x 2,0	95.-	74.50	
12	16,0 x 1,5	17.30	11.80	9.50	28	33 x 2,0	79.-	61.50	
12	17,0 x 1,5	20.-	13.90	11.05	28	36 x 2,0	81.-	63.-	
12	18,0 x 1,0	19.-	13.10	10.50	30	36 x 1,5	53.-	41.-	
12	18,0 x 1,5	21.50	15.-	12.10	30	36 x 2,0	69.50	54.-	
12	18,0 x 2,0	30.25	21.75	17.50	30	38 x 2,0	86.-	67.-	
13	17,0 x 1,5	18.70	12.90	10.10	32	38 x 2,0	77.-	60.-	
13	17,0 x 1,5	22.75	15.90	12.90	33	39 x 2,0	82.-	64.-	
13	18,0 x 1,0	18.50	12.70	10.10	33	41 x 2,0	95.50	78.-	
13	18,0 x 1,5	22.-	15.40	11.50	34	46 x 3,0	110.-	83.50	
13	18,0 x 2,0	26.75	19.10	15.50	35	41 x 2,0	86.50	67.50	
13	20,0 x 1,5	35.25	26.50	21.60	36	42 x 2,0	92.50	72.50	
13	21,0 x 2,0	31.25	22.50	18.25	38	44 x 2,0	93.-	73.-	
14	18,0 x 1,0	17.10	11.60	9.40	40	47 x 2,0	121.-	99.50	
14	18,0 x 1,5	19.30	13.30	10.80	42	49 x 2,0	108.-	88.-	
14	20,0 x 1,5	22.25	15.50	12.30	45	52 x 2,0	127.-	104.-	
15	19,0 x 1,5	34.25	25.75	21.70	48	55 x 2,0	138.-	113.-	
16	20,0 x 1,5	29.50	21.-	17.50	50	57 x 2,0	145.-	119.-	
16	22,0 x 1,5	34.75	26.25	21.50	52	60 x 2,5	184.-	158.-	
16	24,0 x 1,0	43.-	32.75	26.50	60	68 x 2,5	224.-	193.-	
16	24,0 x 2,0	93.50	73.-	65.70	64	72 x 2,5	239.-	206.-	
17	21,0 x 1,5	32.25	23.25	20.95	65	74 x 2,5	252.-	217.-	
17	22,0 x 1,5	51.-	39.25	35.30	75	84 x 2,5	304.-	262.-	

PHOSPHOR - BRONZE

Serrated lock washers

DIN 6798-A externally serrated

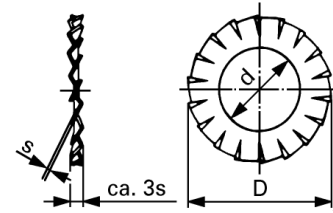

screw	d	D	s	plain	
M	quantity			100	1000
2	2,2	4,5	0,3	7.50	3.95
3	3,2	6	0,4	7.80	4.20
4	4,3	8	0,5	8.40	4.70
5	5,3	10	0,6	12.80	7.70
6	6,4	11	0,7	17.20	11.-
8	8,4	15	0,8	29.75	19.90
10	10,5	18	0,9	47.50	34.-
12	13	20,5	1	63.-	48.50

POLYAMID

Flat washers
normal series

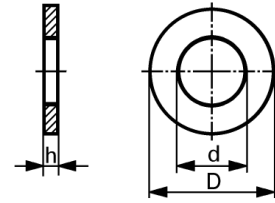

ISO 7089 / DIN 125 A

without chamfer

screw	d	D	h	plain		
				100	1000	10 000
M	quantity					
2,5	2,7	6	0,5	7.10	4.60	3.40
3	3,2	7	0,5	6.–	2.80	1.65
4	4,3	9	0,8	6.–	3.20	2.05
5	5,3	10	1	6.90	4.40	3.25
6	6,4	12	1,6	9.10	5.80	4.30
(7)	7,4	14	1,6	15.50	11.40	10.20
8	8,4	16	1,6	12.30	7.90	6.–
10	10,5	20	2	15.70	10.70	10.30
12	13	24	2,5	31.75	20.25	15.80
(14)	15	28	2,5	34.–	22.50	17.60
16	17	30	3	35.–	23.25	18.10
20	21	37	3	61.50	41.–	32.25
24	25	44	4	124.–	86.–	70.–

POLYAMID

Flat washers

ISO 7093 / DIN 9021

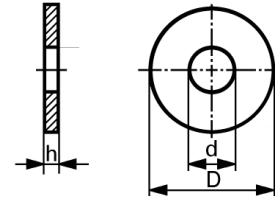

screw	d	D	h	plain		
				100	1000	10 000
M	quantity					
3	3,2	9	0,8	7.-	4.90	4.30
4	4,3	12	1	7.20	5.-	4.50
5	5,3	15	1,6	10.-	7.20	6.10
6	6,4	18	1,6	12.50	8.30	6.90
8	8,4	24	2	24.-	18.-	16.20
10	10,5	30	2,5	28.50	22.40	19.50
12	13	37	3	42.-	30.60	28.55
16	17	50	3	92.-	72.-	66.-
20	22	60	4	99.50	81.-	76.50

POLYAMID

Sealing and locking rings, SKIFFY

K 640

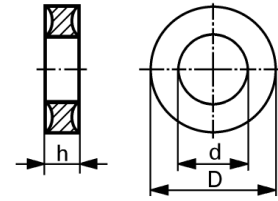

screw	d	D	h	plain	
M	quantity			100	1000
2,5	2,6	6	2,2	20.50	15.20
3	3,1	8	2,5	21.75	16.50
4	4,2	10	2,8	22.50	17.90
5	5,2	10,7	3	24.75	19.10
6	6,2	12,7	3,8	29.–	23.–
8	8,2	16,2	4,2	32.25	26.75
10	10,2	20	5	49.–	36.–
12	12,2	24	5,2	64.50	55.50
14	14,2	26	5,6	90.50	73.–
16	16,2	30	5,9	103.–	89.–
20	20,3	36	6,8	173.–	153.–

ALUMINIUM

Flat washers
normal series

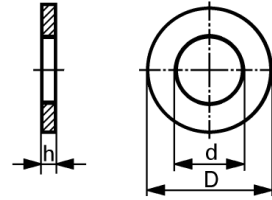

ISO 7089 / DIN 125 A

without chamfer

screw	d	D	h	plain		
M	quantity			100	1000	10 000
3	3,2	7	0,5	5.-	2.20	1.55
4	4,3	9	0,8	5.-	2.20	1.55
5	5,3	10	1	5.50	2.55	1.90
6	6,4	12	1,6	7.-	3.85	2.95
8	8,4	16	1,6	10.10	6.60	5.10
10	10,5	20	2	18.50	11.80	9.20
12	13	24	2,5	31.50	20.-	15.90
(14)	15	28	2,5	43.-	31.50	24.75
16	17	30	3	45.-	33.40	26.10

ALUMINIUM

Finishing washers, steel
for 90° countersunk head screws

SN 213912

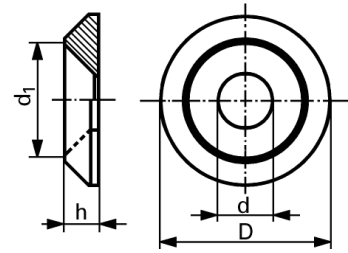

screw	d	D	d1	h	plain	
			+0,2	-0,2		
M	quantity				100	1000
3	3,2	10	7,3	2	20.50	18.45
3,5	3,7	12	8,4	2,3	22.-	19.80
4	4,3	14	9,5	2,5	22.50	20.25
5	5,3	16	11,5	3	26.50	23.85
6	6,4	18	13,5	3,5	27.75	24.97
8	8,4	25	17,5	5	66.50	59.85